

BASIN UNIT

CALIBRE SINGLE DRAWER BASIN UNIT INC SOLID SURFACE BASIN

600



SPECIFICATION

- 18mm thick cabinet materials used throughout including back panel
- Matching pressed sides & front panels for perfect colour match.
- Handle-less design - Pull top of drawer to open.
- Soft-close drawers.
- Cabinets are supplied fully assembled.
- Includes a pair of suspension brackets and fixing plates, Wall fixings not included.
- Installation instructions supplied with product.
- Sit on basin no cutting required
- Single taphole Solidsurface basin with overflow - Pre Drilled
- Removable feature panels to gain easy access to pipes.
- Additional handle choices if required.



External Finish Options

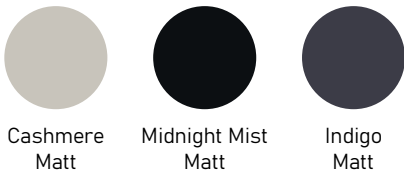

DIMENSIONS (MM):

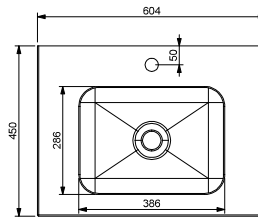

Internal Finish Options

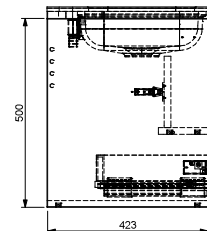
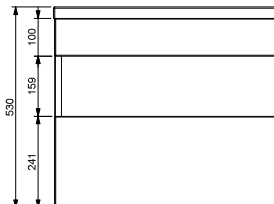
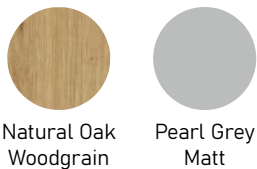

DOOR STYLE:



Horizontal Fluted



Plain

External Finish	Internal Finish	Fluted	Plain
● Cashmere	Natural Oak	CA6SDUNOF/INT	CA6SDUNOS/INT
● Cashmere	Pearl Grey	CA6SDUPGF/INT	CA6SDUPGS/INT
● Midnight Mist	Natural Oak	CA6SDUNOF/INT	CA6SDUPGS/INT
● Midnight Mist	Pearl Grey	CA6SDUPGF/INT	CA6SDUPGS/INT
● Indigo	Natural Oak	CA6SDUNOF/INT	CA6SDUNOS/INT
● Indigo	Pearl Grey	CA6SDUPGF/INT	CA6SDUPGS/INT



— est. 1964 —